



St. Bernard Parish Library

2600 Palmisano Blvd.
Chalmette, LA 70043
504-279-0448 504-279-5427 FAX

Response to RFI #76 – Timeclock height 06/10/2024

Please mount a counter-sunk box containing the Ethernet connection at 4'2" AFF located on the LEFT side of the wall to allow for the storage rack of timecards on the right. The timeclock measures 5" wide by 5.75" high by 2" deep. It has a metal mounting bracket/plate with holes to allow a small 6-8" Ethernet cord to be plugged in from the recessed box jack into the back of the clock. The timeclock is powered by POE, so no external power is needed. See drawings.

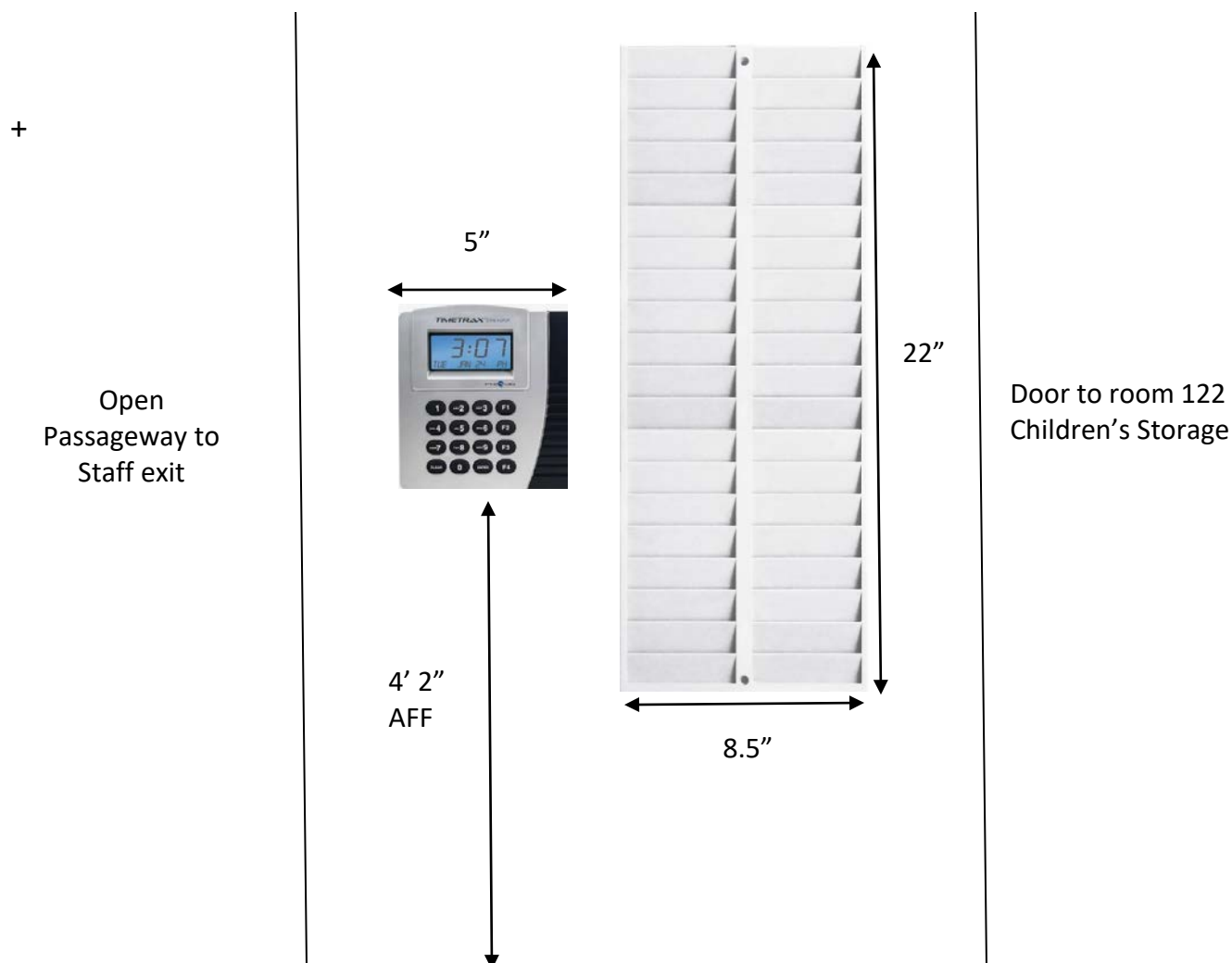



Mount Terminal

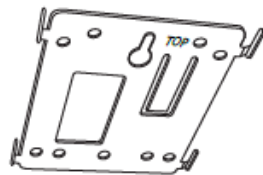
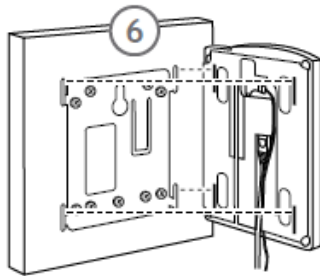

To mount terminal.

- Install mounting bracket. Use mounting screws and drill template provided. “TOP” is engraved to ensure bracket is oriented correctly and the tabs face upwards.
- Additional holes are provided if mounting onto an electrical box.
- Push terminal onto mounting bracket aligning four tabs on bracket with four matching slots on back of terminal. *Be sure to write down the terminal serial number before mounting.* Slide terminal downward until locking tab clicks into place. When properly mounted, terminal cannot be removed from the bracket without using the included wall bracket release key to disengage locking tab.
- Cables may be rooted through channel at base of terminal or by drilling a hole in the rectangular section of the mounting bracket and through the wall for concealing cables.

To detach terminal.

- Insert key (tab facing outward) into narrow slot located on bottom of terminal to right of cable access cutout.
- Push key all the way up into slot. Key will slide easily until last ½ inch until some resistance from locking tab is felt.
- With key fully pushed into slot, slide the terminal up and off mounting bracket.



Connect Terminal

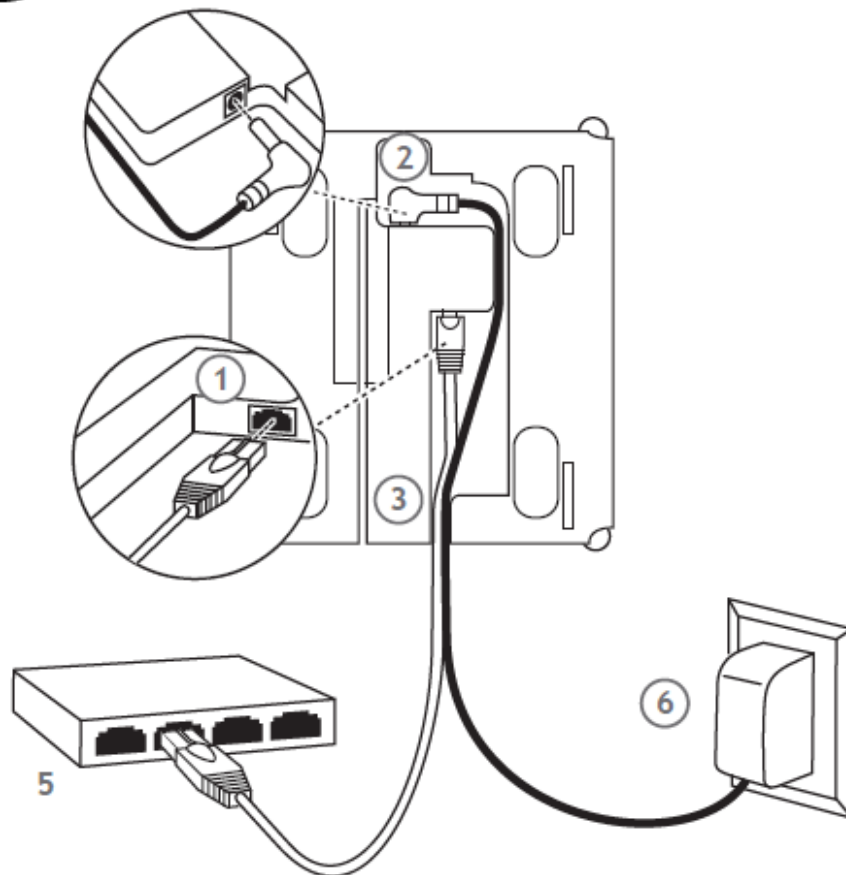

- 1 Connect either end of RJ45 cable into “**ETHERNET**” port located on the back of time clock terminal.
- 2 Connect power supply into “**POWER**” port located in compartment on back of terminal.
- 3 Route the cables through channel at base of terminal.
- 4 Mount terminal (see instructions below).
- 5 Plug free end of RJ45 cable into a DHCP network jack, router or switch.
- 6 Plug supply into outlet.

Power wall-wart is not needed because the timeclock is being powered by ethernet POE. Drawing is to show back of timeclock for reference.